

PRU2 Turntable
Instruction & Maintenance Manual
PRU2 转台安装使用维护手册

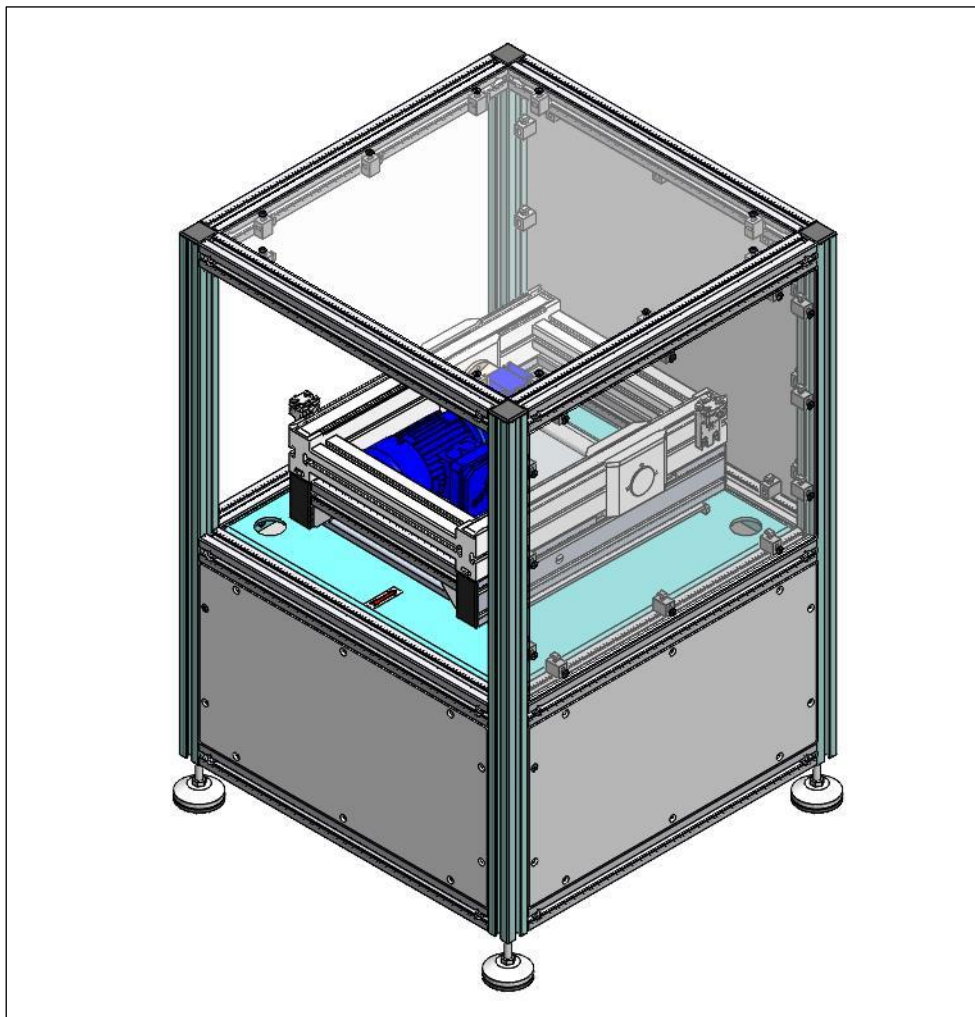

Suzhou LinkedGo Transfer System Co.,Ltd.

苏州领科工业技术有限公司

Structure Diagram 结构示意图

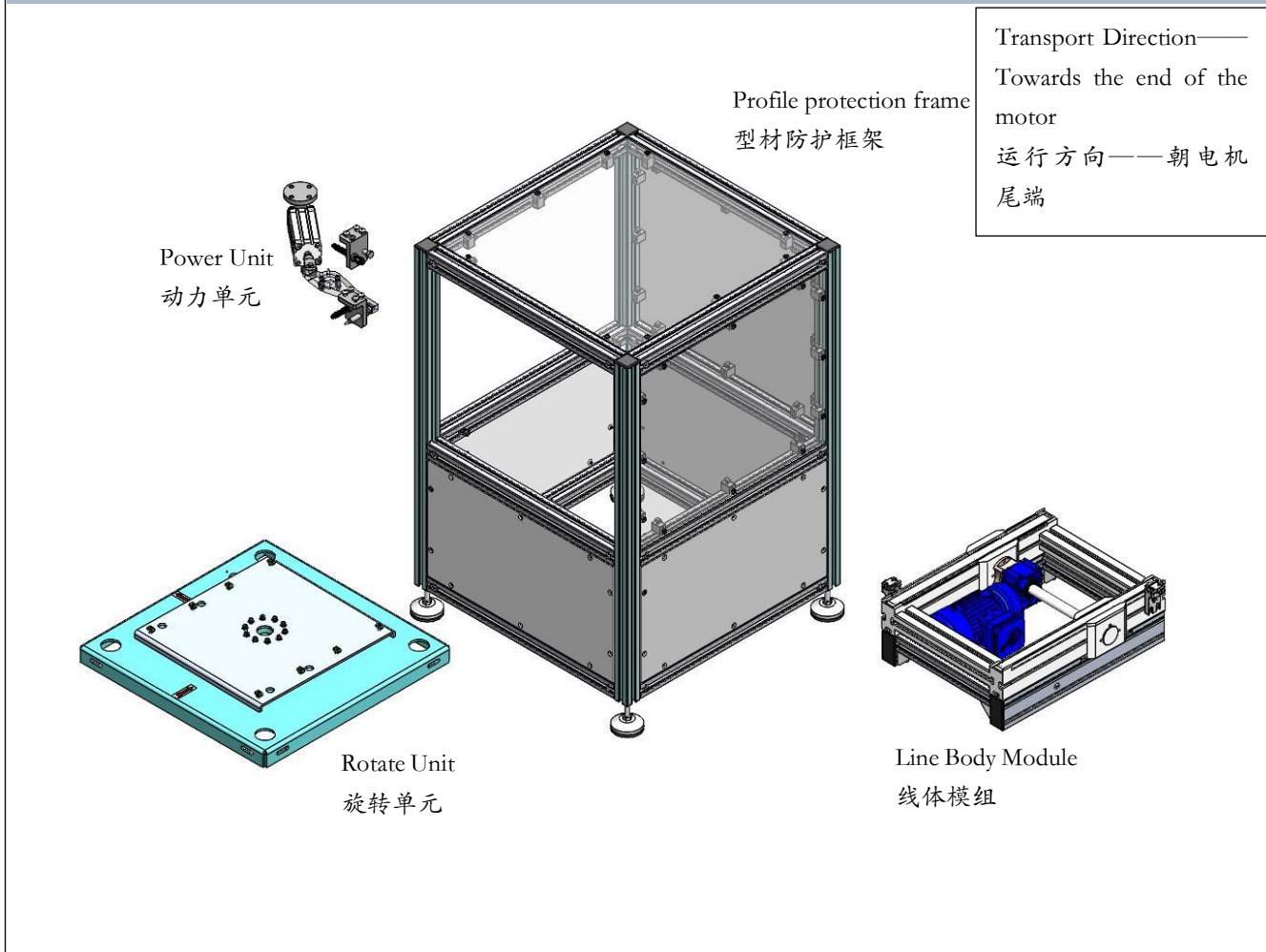

产
品
特
征

安
装
步
骤

维
护
保
养

1. The effective width Bwp of the horizontal conveyor line is 160-480mm, and the effective width Lwp of the vertical conveyor line is 240-480mm, which can be customized according to customer requirements.
- 1、横向输送线的有效宽度 Bwp 为 160-480mm, 纵向输送线的有效长度 Lwp 为 240-480mm, 可根据客户要求定制。
2. The conveying medium is a synchronous belt.
- 2、输送介质为同步带。
3. The total amount of PRU2-30 workpiece tray can reach up to 30kg; The total amount of PRU2-60 workpiece tray can reach up to 60kg.
- 3、PRU2-30 型工件托盘总量最多达 30kg; PRU2-60 型工件托盘总量最多达 60kg。
4. The motor can be installed on the right, left, and middle of the body.
- 4、电机可安装在线体右侧、左侧、中间。
5. Can run in reverse.
- 5、可反向运行。

Model Description 型号说明

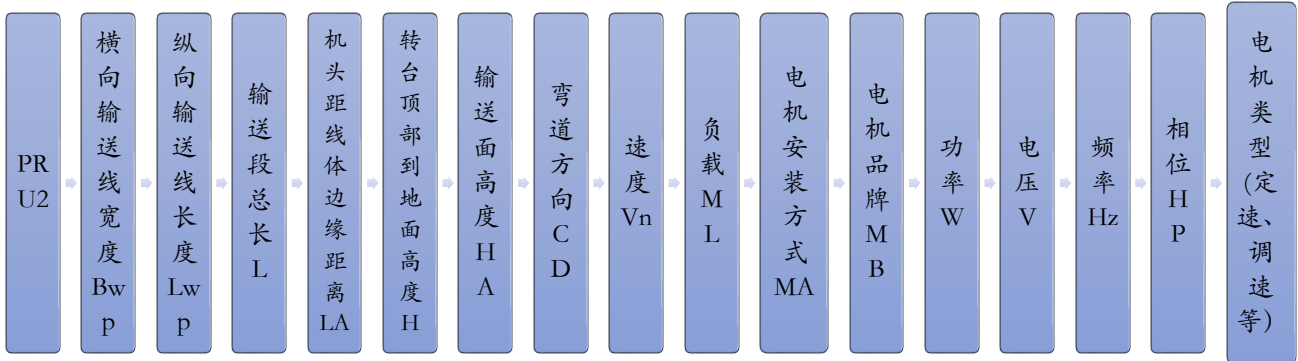

例： PRU2/30-Bwp320-Lwp400-L620-LA130-H1074-HA600-CDL-Vn18-

ML30kg,MA=MAL011A,MB=JSCC-120W-220V-50Hz-1Hp-C0

The model PRU2/30-Bwp320-Lwp400-L620-LA130-H1074-HA600-CDL-Vn18-ML30kg,MA=MAL011A,MB=JSCC-120W-220V-50Hz-1Hp-C0 represents a horizontal conveyor line with a width of 320mm, a vertical conveyor line with a length of 400mm, a total length of 620mm for the conveyor section, a distance of 130mm from the head to the edge of the line, a height of 1074mm from the top of the turntable to the ground, a conveyor surface height of 600mm, a running speed of 18m/min, a running load of 30kg, a motor installation position of L011A, a motor brand of JSCC, a power of 120W, a voltage of 220V, a frequency of 50Hz, and a phase of 1 for a constant speed motor.

型号 PRU2/30-Bwp320-Lwp400-L620-LA130-H1074-HA600-CDL-Vn18-ML30kg,MA=MAL011A,MB=JSCC-120W-220V-50Hz-1Hp-C0, 表示横向输送线体宽度 320mm, 纵向输送线长度 400mm, 输送段总长 620mm, 机头距线体边缘距离为 130mm, 转台顶部到地面高度为 1074mm, 输送面高度为 600mm, 运行速度 18m/min, 运行负载 30kg, 电机安装位置为 L011A, 电机品牌为 JSCC, 功率为 120W, 电压为 220V, 频率为 50Hz, 相位为 1 的定速电机。

产品特征

安装步骤

维护保养

参数说明 Parameter Description

品名 Product Name	横向输送 线宽度 (mm) Bwp	纵向输送线 长度(mm) Lwp	速度 (m/min) Speed	电机安装方式 Motor installation method
PRU2	160~480	240~480	6~18	<p>电机安装: MA=①_②_③_④_⑤_</p> <p>Motor installation: MA=①_②_③_④_⑤_</p> <p>①电机安装位置: R=右; L=左;</p> <p>Motor installation position: R=right; L=Left;</p> <p>②当①=R/L时, ②=0;</p> <p>② When ①=R/L, ②=0;</p> <p>③电机安装位置: 1、2、3、4;</p> <p>Motor installation position: 1, 2, 3, 4;</p> <p>④接线盒位置: 1、2、3、4;</p> <p>Location of junction box: 1, 2, 3, 4;</p> <p>⑤出线口方向: A、B、C、D;</p> <p>Outlet direction: A, B, C, D;</p>

产品特征

安装步骤

维护保养

安装步骤 Installation steps

Assemble the profile frame. There are two connection methods between profiles, A: connectors and B: angle aluminum.

A 组装型材框架。型材之间采取两种连接方式，A：连接件，B：角铝。

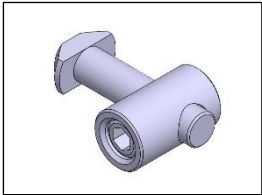

A

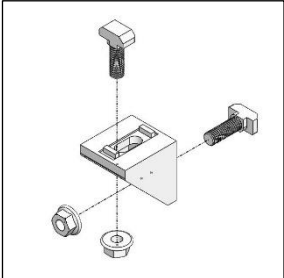

B

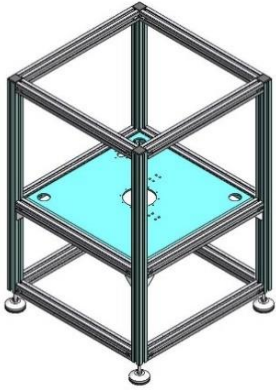
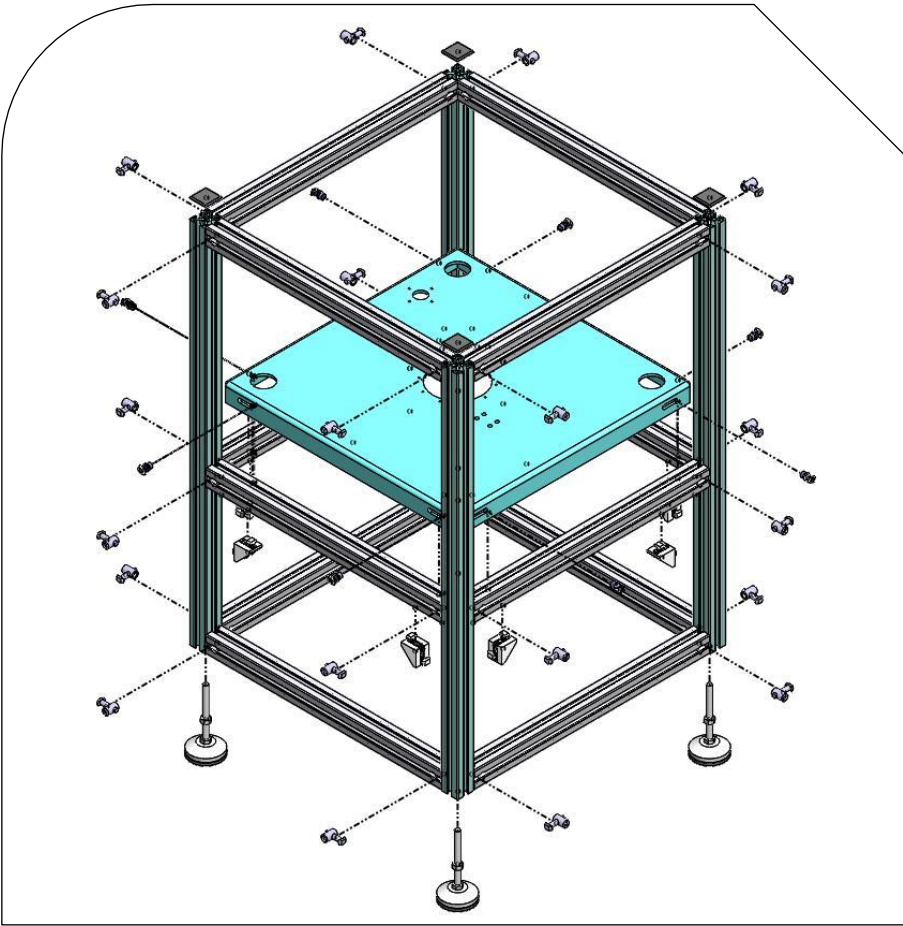

产
品
特
征

安
装
步
骤

维
护
保
养

B Install the rotating unit. For the convenience of viewing, some frames are now hidden.

B 安装旋转单元。为方便观看，现隐藏部分框架。

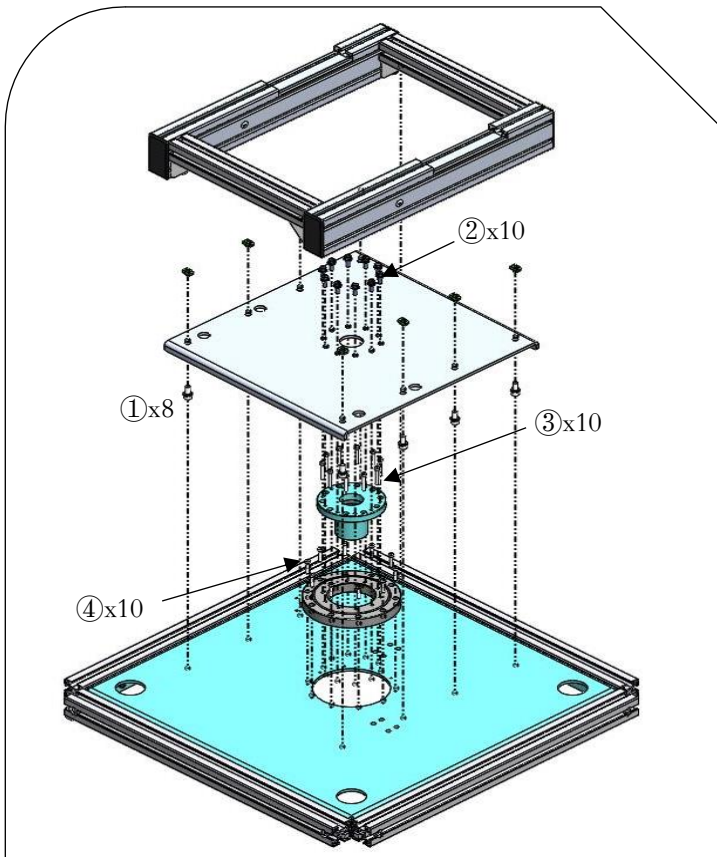

Rotary support
回转支撑



 Attention: The slewing support needs to be inspected regularly and whether oil injection is necessary according to the situation (do not inject liquid oil!)
注意：回转支撑需定期检查，根据具体情况判断是否需要注油（*请勿注液体油！）

- ① — M8x20
⑥ 13Nm
- ③ — M5x35
⑤ 8Nm

- ② — M6x20
⑥ 13Nm
- ④ — M5x25
⑤ 8Nm

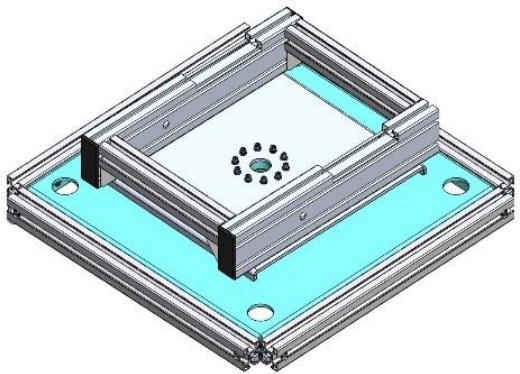

产品特征

安装步骤

维护保养

C Assemble the power module. For the convenience of viewing, some frames will be hidden during the assembly process.

C 组装动力模块。为方便观看，组装过程中会隐藏掉部分框架。

Pre assembled stopper assembly
预组装阻挡器组件

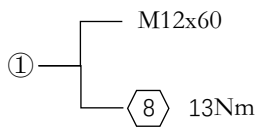
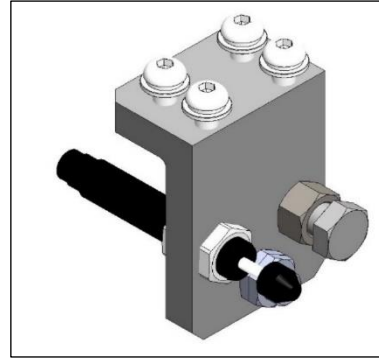
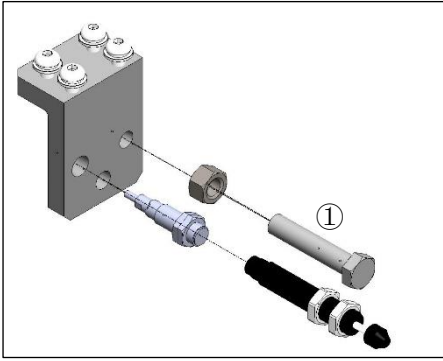

Pre assembled cylinder module
预组装气缸模组

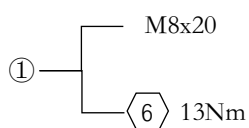
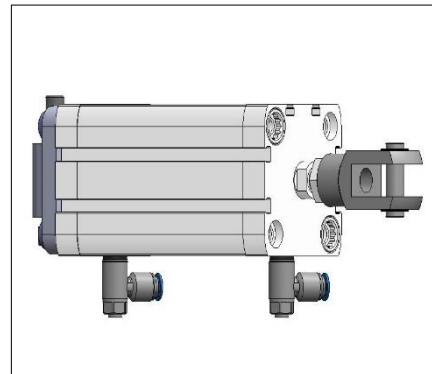
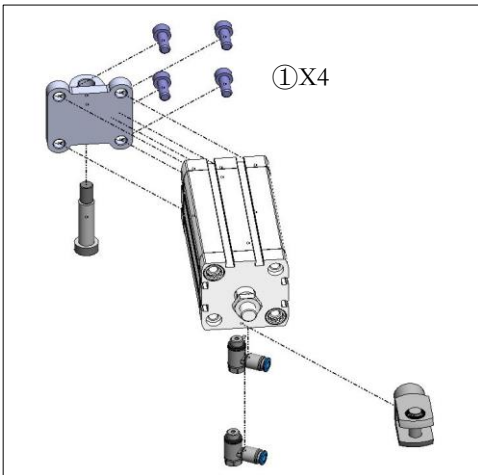

产
品
特
征

安
装
步
骤

维
护
保
养

Installing power module
安装动力模块

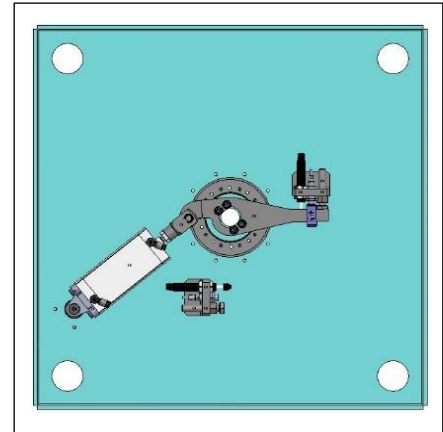
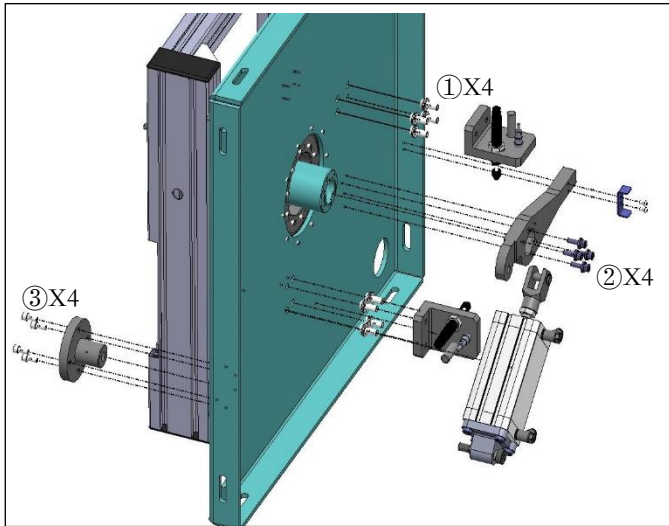

① — M8x20
⑥ 13Nm

② — M6x20
⑥ 13Nm

① — M6x14
⑤ 5Nm

D Install the wire module. For details on wire assembly, please refer to the TBC2-M Installation, Use, and Maintenance Manual.

D 安装线体模组，线体组装详情可参见 TBC2-M 安装使用维护手册。

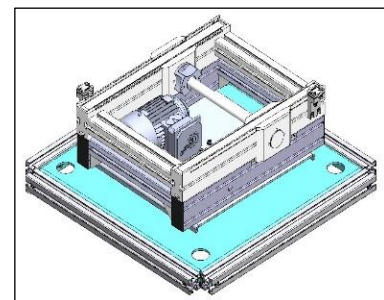
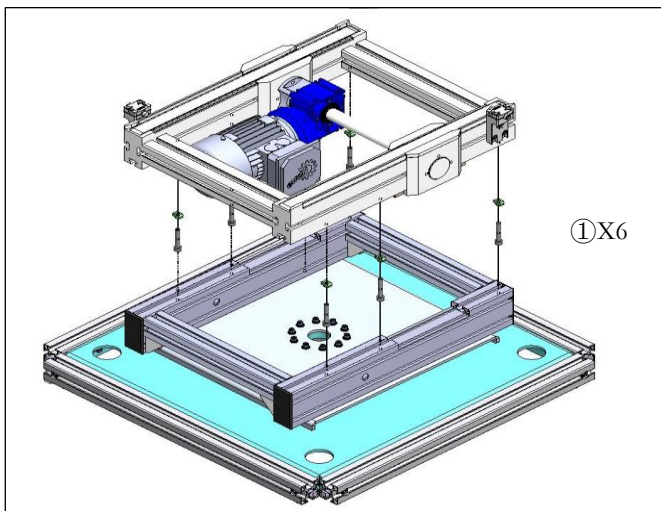

② — M8x45
⑥ 13Nm

E Install the cover.

E 安装护罩。

PC installation method

PC 安装方式

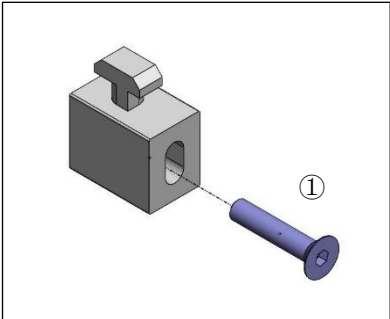

M6x30
①
5 5Nm

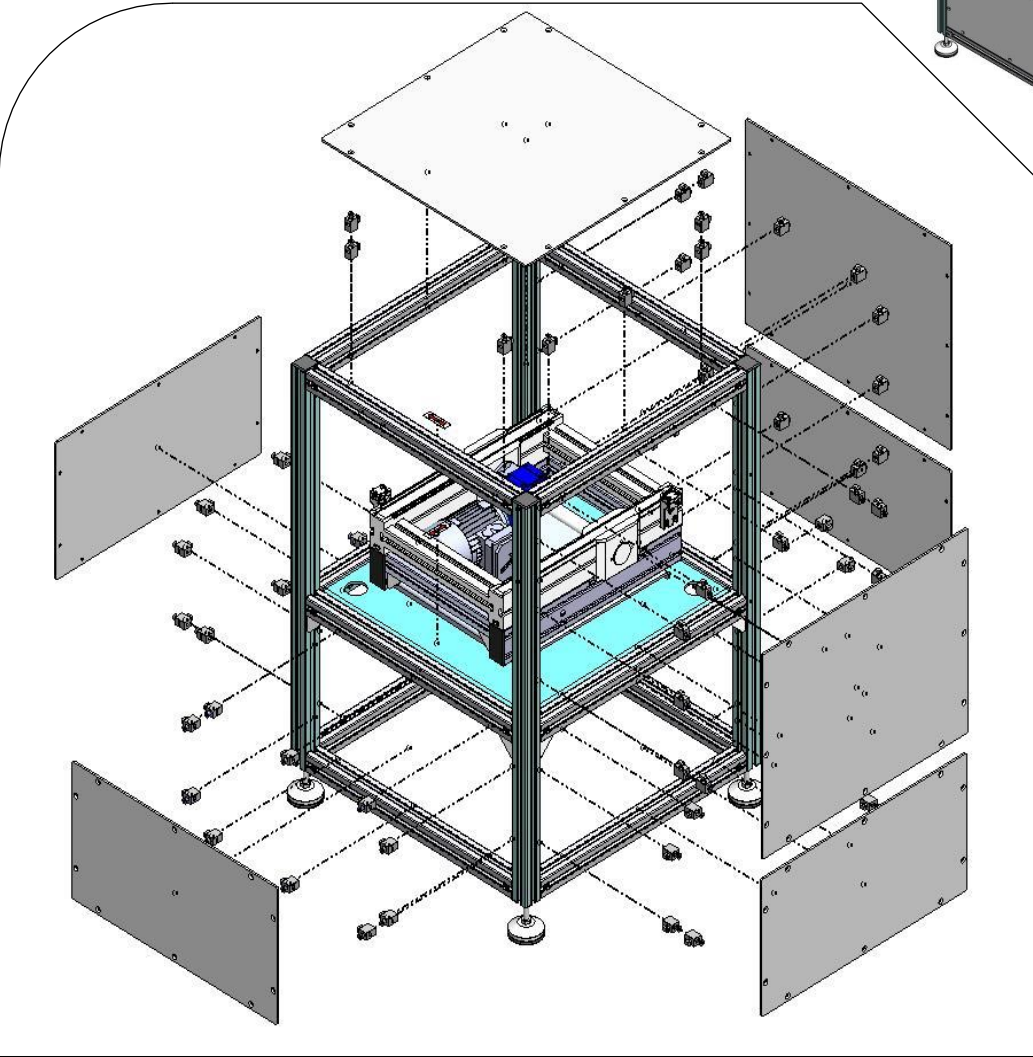
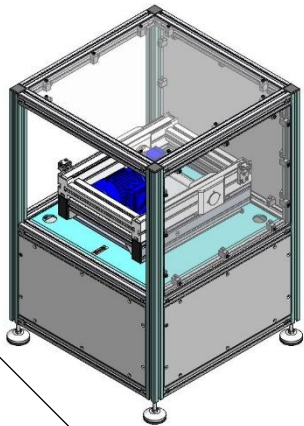

F Regular Troubleshooting.

F 常见故障及处理方法。

1. Motor overheating: Check if the equipment is operating under overload and if the motor wiring is loose.

1、电机过热：检查设备是否超载运作，电机接线是否松动。

2. Drive unit abnormal noise: Check if the motor sprocket and bearings need lubrication.

2、驱动单元异响：检查电机链轮、轴承是否需要润滑。

Maintenance 维护和保养

The UTS series tray conveying system requires regular maintenance and upkeep to extend the service life of the line. The conveying equipment should be kept clean to avoid direct sunlight or rain or snow, and to prevent contact with substances such as acids, alkalis, oils, organic solvents, etc.

UTS 系列托盘输送系统需按周期进行规定的保养维护工作，以延长线体使用寿命。输送设备应保持清洁避免阳光直射或雨雪浸淋，防止与酸、碱、油类、有机溶剂等物质接触。维护前需关闭对应的能源供给。

Daily Maintenance

日维护

Regularly clean the conveyor line. Before starting the machine every day, it is necessary to clean the floating dust, falling small parts, and other obstacles on the chain and wire body to prevent dust and dirt from affecting the operation of the wire body. When cleaning the machine head, it is necessary to remove the upper cover of the machine head, and use an air gun to remove the accumulated dust inside. During trial operation, check whether there are any abnormalities in various parts of the conveyor line, such as loose bearings or abnormal noise. Once any abnormalities are found, repair and replace them immediately.

定期清洁输送线。每日开机前需清理链条及线体上的浮尘、掉落的小零件及其他障碍物，防止积尘和污垢影响线体运行。在清洁机头时，需拆掉机头上盖，用气枪清除里面积压的灰尘。试运行前，检查输送线的各部位是否有异常，如轴承有无松动或异常噪音，一旦发现异常应立即维修和更换。

Weekly Maintenance

周维护

Regularly inspect the accessories on the conveyor line body. For parts that are prone to damage such as bearings, Friction parachute tooth, maintenance, and lubrication are required. If damage or looseness is found, it must be replaced immediately. Check if the fasteners on the wire body are loose and tighten them in a timely manner.

定期检查输送线体上的附件。对于轴承、摩擦伞齿等容易损坏的零件，需定期检查、保养和润滑。发现损坏和松动须立即更换。检查线体上的紧固件是否有松动情况，及时紧固。

Monthly Maintenance

月维护

Regularly clean motor bearings, check for wear, and replace lubricating oil in a timely manner. (It is necessary to replenish the oil at any time based on the on-site operating conditions and the degree of oil volatilization. Under normal operation, the lubricating oil can be replaced every six months.)

对于电机轴承等定期清洗，检查磨损情况，及时更换润滑油。（需根据现场运行状况及油脂挥发程度进行随时补油，正常运行下，可六个月更换一次润滑油。）

Quarterly Maintenance

季度维护

Check the wear of bearings, idlers, pulleys, and synchronous wheels, and replace them in a timely manner. Check if the toothed belt is loose or deformed, and if the friction strip is severely worn, and replace it in a timely manner. Confirm that the operation is in good condition, without any belt jamming, slipping, deviation, or abnormal noise from the wire body. If this situation occurs, it is necessary to check whether the internal structure of the drive unit and rotary unit is intact.

检查轴承、惰轮、滑轮、同步轮的磨损情况，及时更换。检查齿形带是否松弛变形，磨擦条是否磨损严重，并及时更换。确定运行状况良好，无皮带卡顿、打滑、偏移及线体异响的情况发生，如有此情况，需检查驱动单元、回转单元是否内部结构完好。

Disclaimer

免责声明

The customer shall inspect the equipment regularly. If the customer fails to maintain the conveyor as the state above, leading to any malfunction or damage to the conveyor, our company will not be responsible for it, all related costs (including material costs, installation and commissioning fees, and hotel expense) shall be borne by the customer.

客户应定期对设备进行检查。若客户未按要求对输送机进行维护，进而导致输送机发生任何故障或损坏，我司将不承担相关责任，由此产生的相关费用（材料费，安装调试费，差旅费）均由客户承担。

Suzhou LinkedGo Transfer System Co.,Ltd.
苏州领科工业技术有限公司

[Tel: +86-512-6636 1885](tel:+86-512-66361885)

Add: Room 706, Building D, Dongchuang Science and Technology Park, No.
216 Jinfeng Road, Wuzhong District, Suzhou, P.R. China

Zip code:215101

E-mail: Sales@LinkedGo.com.cn

Website: [www. LinkedGo.com.cn](http://www.LinkedList.com.cn)

Subject to technical modifications

电话: +86-512-6636 1885

地址: 苏州市吴中区木渎镇金枫路 216 号东创科技园 D 幢 706 室

邮编: 215101

邮箱: Sales@LinkedGo.com.cn

网址: www.LinkedList.com.cn

我司保留技术更改的权利